

 **Oriental Center**
Bahria Oriental Garden

Possession in
1.5 YEAR

 **RABT**
MARKETING

1st Oct 2023

BOOKING FROM 25%

A Good Location is Everything
Shops | Offices | Apartments

Rabt Marketing, office # 6, 4th Floor, Pakland City Center,
I-8 Markaz, Islamabad - 44000 Pakistan.

 **RABT**
MARKETING

For Booking & Details:
0311-4539207

Live a prime life
in a prime location.





Oriental Center

Bahria Oriental Garden

Oriental Heights is one of Light House's most popular projects, located in Bahria Oriental Garden. Covering an area of 1 kanal, it is a mixed-use property with commercial and residential units. Its design focuses on maximum comfort, making it an attractive and transformational place. Oriental Heights provides studio, 1 and 2 bed apartments, as well as budget friendly shops.

AREA

1.5 KANALS

FLOORS

5

INSTALLMENTS

24

COMPLETION TIME

2 YEARS

LOWER GROUND FLOOR PREMIUM SHOPS



Office No. 6, 4th Floor, Pakland City Center,
I-8 Markaz, Islamabad - 44000 Pakistan.



For Booking & Details:
0311-4539207

LOWER GROUND FLOOR PREMIUM SHOPS



Unit Numbers	Size Sq Ft	Booking 25%	2% X 24 Monthly	17% On Possession	10% On Transfer	Total Amount
6	183.1	1,261,700	2,460,864 2 % = 102,534 x 24	871,576	512,680	5,126,800
1, 2, 3, 4, 5, 8, 9, 10, 11	340.0	2,520,000	4,838,400 2 % = 201,600 x 24	1,713,600	1,008,000	10,080,000
7	342.2	2,535,400	4,862,968 2 % = 202,832 x 24	1,734,072	1,014,160	10,141,600
12	367.5	2,872,500	4,939,200 2 % = 205,800 x 24	1,749,300	1,029,000	10,290,000

Office No. 6, 4th Floor, Pakland City Center,
I-8 Markaz, Islamabad - 44000 Pakistan.



For Booking & Details:
0311-4539207

GROUND FLOOR PREMIUM SHOPS

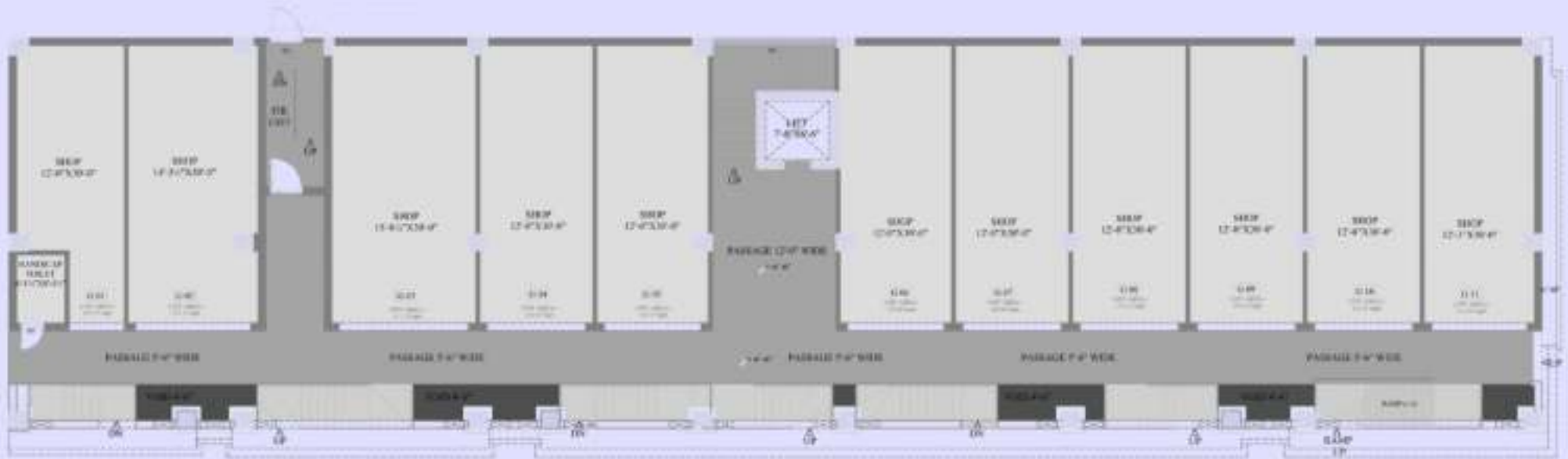

Office No. 6, 4th Floor, Pakland City Center,
I-8 Markaz, Islamabad - 44000 Pakistan.

GROUND FLOOR PREMIUM SHOPS



Unit Numbers	Size Sq.Ft	Booking 25%	2% X 24 Monthly	17% On Possession	10% On Transfer	Total Amount
1	310.2	3,877,500	7,444,800 2% = 310,200 x 24	2,626,700	1,581,000	15,510,000
6	358.8	4,485,000	8,611,200 2% = 358,800 x 24	3,049,800	1,794,000	17,940,000
4, 5, 7, 8, 9, 10	360.0	4,500,000	8,140,000 2% = 360,000 x 24	3,060,000	1,800,000	18,000,000
11	367.0	4,587,500	8,808,000 2% = 367,000 x 24	3,119,500	1,835,000	18,350,000
2	428.8	5,360,000	10,291,200 2% = 428,800 x 24	3,644,800	2,144,000	21,440,000
3	471.2	5,890,000	11,308,800 2% = 471,200 x 24	4,005,200	2,364,000	23,560,000

Office No. 6, 4th Floor, Pakland City Center,
I-8 Markaz, Islamabad - 44000 Pakistan.



For Booking & Details:
0311-4539207

FIRST FLOOR MODERN OFFICES



Office No. 6, 4th Floor, Pakland City Center,
I-8 Markaz, Islamabad - 44000 Pakistan.



For Booking & Details:
0311-4539207

FIRST FLOOR MODERN OFFICES



Category	Unit Numbers	Size Sq.Ft	Booking 25%	2% X 24 Monthly	17% On Possession	10% On Transfer	Total Amount
Standard	104	420.3	2,943,500	5,687,530 2% = 235,480 x 24	2,001,580	1,177,400	11,774,000
	107	426.4	2,984,800	5,730,816 2% = 238,784 x 24	2,029,664	1,193,920	11,931,200
	114	439.5	3,076,500	5,905,800 2% = 246,120 x 24	2,092,020	1,230,600	12,306,000
	101	490.2	3,431,400	6,588,380 2% = 274,512 x 24	2,333,352	1,372,560	13,725,600
	113	526.8	3,687,600	7,080,192 2% = 295,008 x 24	2,507,568	1,475,040	14,750,400
	110, 111, 112	530.6	3,714,200	7,131,264 2% = 297,136 x 24	2,525,666	1,485,260	14,856,800
	108, 109	534.1	3,738,700	7,178,304 2% = 299,096 x 24	2,542,316	1,495,480	14,954,800
	106	673.7	4,715,900	9,084,528 2% = 377,272 x 24	3,206,812	1,886,360	18,963,600
Studio	105	320.7	2,244,900	4,390,208 2% = 179,592 x 24	1,526,532	897,960	8,979,600
	103	370.3	2,692,100	4,976,832 2% = 207,368 x 24	1,762,628	1,036,340	10,368,400
	102	373.8	2,616,400	5,023,872 2% = 209,328 x 24	1,779,288	1,046,640	10,466,400

Office No. 6, 4th Floor, Pakland City Center,
I-8 Markaz, Islamabad - 44000 Pakistan.



For Booking & Details:
0311-4539207

SECOND FLOOR LUXURY APARTMENTS



Office No. 6, 4th Floor, Pakland City Center,
I-8 Markaz, Islamabad - 44000 Pakistan.



For Booking & Details:
0311-4539207

SECOND FLOOR LUXURY APARTMENTS



Category	Unit Numbers	Size Sq.Ft	Booking 25%	2% X 24 Monthly	17% On Possession	10% On Transfer	Total Amount
1 Bed	204	419.7	1,468,950	2,820,384 2% = 117,556 x 24	998,886	587,580	5,875,800
	201	489.2	1,712,200	3,287,424 2% = 136,976 x 24	1,164,296	684,880	6,648,800
	210, 211	537.4	1,880,900	3,611,328 2% = 150,472 x 24	1,279,012	752,360	7,523,600
	209	538.4	1,884,400	3,618,048 2% = 150,752 x 24	1,281,392	753,760	7,537,600
	208	538.5	1,884,750	3,618,720 2% = 150,780 x 24	1,281,630	753,900	7,539,000
	206	687.9	2,407,650	4,622,688 2% = 192,612 x 24	1,637,202	963,060	9,630,600
2 Bed	207	956.2	3,346,700	6,425,664 2% = 267,736 x 24	2,275,756	1,338,680	13,386,800
	212	978.8	3,418,300	6,557,376 2% = 273,224 x 24	2,322,404	1,366,120	13,661,200
Studio	205	329.4	1,182,900	2,213,568 2% = 92,232 x 24	783,972	461,160	4,611,600
	203	369.6	1,293,600	2,483,712 2% = 103,488 x 24	879,648	517,440	5,174,400
	202	373.1	1,305,850	2,507,232 2% = 104,468 x 24	887,978	522,340	5,223,400

Office No. 6, 4th Floor, Pakland City Center,
I-8 Markaz, Islamabad - 44000 Pakistan.



For Booking & Details:
0311-4539207

THIRD FLOOR LUXURY APARTMENTS



Office No. 6, 4th Floor, Pakland City Center,
I-8 Markaz, Islamabad - 44000 Pakistan.



For Booking & Details:
0311-4539207

THIRD FLOOR LUXURY APARTMENTS



Category	Unit Numbers	Size Sq.Ft	Booking 20%	2% X 24 Monthly	17% On Possession	10% On Transfer	Total Amount
1 Bed	305	328.7	1,150,450	2,208,864 2 % = 92,036 x 24	782,306	460,180	4,601,800
	304	418.7	1,465,450	2,813,664 2 % = 117,236 x 24	996,506	586,180	5,861,800
	301	488.1	1,708,350	3,280,032 2 % = 136,668 x 24	1,161,678	683,340	6,833,400
	308, 309, 310, 311	543.4	1,901,900	3,651,648 2 % = 152,152 x 24	1,293,292	760,760	7,607,600
	306	686.4	2,402,400	4,612,608 2 % = 192,192 x 24	1,633,632	960,960	8,609,600
2 Bed	307	969.5	3,393,250	6,516,040 2 % = 271,460 x 24	2,307,410	1,367,300	13,573,000
	312	993.1	3,475,850	6,673,632 2 % = 278,068 x 24	2,363,578	1,390,340	13,903,400
Studio	303	368.8	1,290,600	2,478,336 2 % = 103,264 x 24	877,744	516,320	5,163,200
	302	372.3	1,303,050	2,501,856 2 % = 104,244 x 24	886,074	521,220	5,212,200

Office No. 6, 4th Floor, Pakland City Center,
I-8 Markaz, Islamabad - 44000 Pakistan.



For Booking & Details:
0311-4539207